



# Installation instruction

## CobiNet RJ45-TL<sup>®</sup> rapid UTP

Double jack, Kat. 6A, unshielded

P/N: 125746

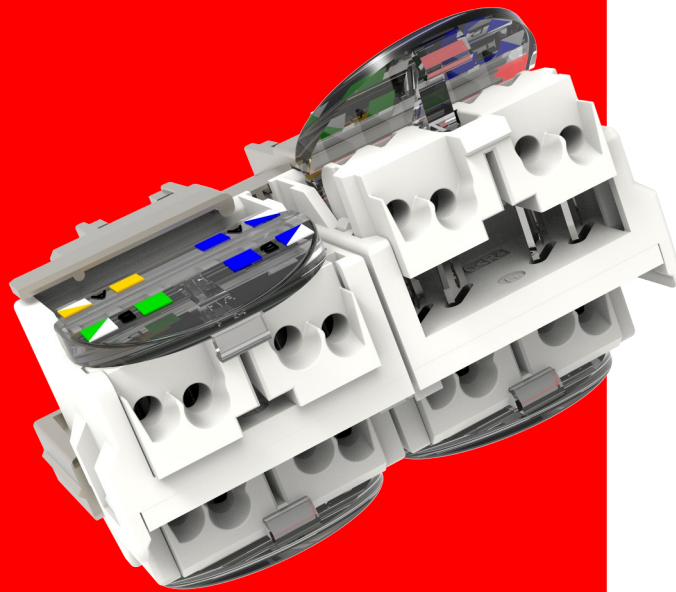

THE GERMAN  
**DEVELOPER  
AND PRODUCER**  
FOR OUTSTANDING  
NETWORK-PERFORMANCE

09/2023 V1

**CobiNet**  
Fernmelde- und Datennetz-  
komponenten GmbH

Robert-Bosch-Straße 33  
68542 Heddesheim

Telefon +49 6203 4900-0  
Telefax +49 6203 4900-88

Internet [www.cobinet.com](http://www.cobinet.com)  
E-Mail [info@cobinet.com](mailto:info@cobinet.com)

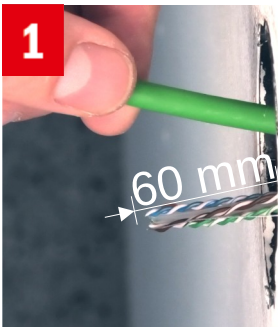

Set down the cable sheath 60 mm and cut off the inner plastic strand and the thread.

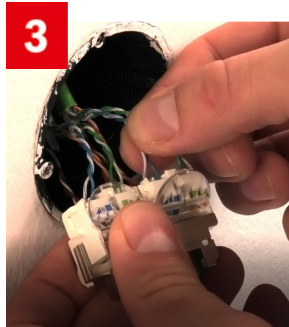
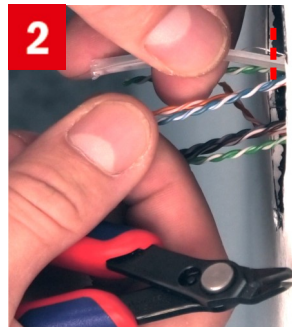

Open the slider with the lever to the stop.

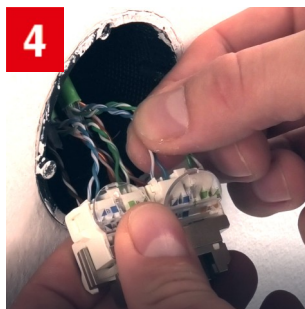

Insert wire pairs into the holes of the sliders to the stop according to the printed color code. Visually check before closing. Then close the lever by pressing it down with your finger.

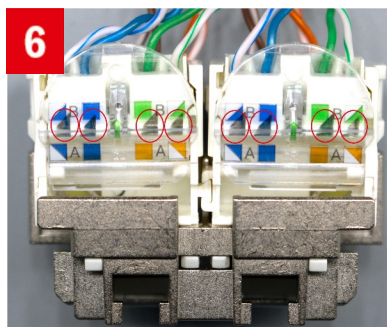

Repeat the connecting with the remaining wire pairs according to Figures 4 and 5. Visually check the single sliders for correct contact.

**Note:**

To reopen the slides, in case of necessary correction, push the lever upwards. Optionally, place a screwdriver under the slider to help.

## Installation in empty wall outlet

(Art.Nr. / P/N: 127138)



Align the mounting plate according to the labeling. The module will be inserted into the gray plastic adapter from behind.

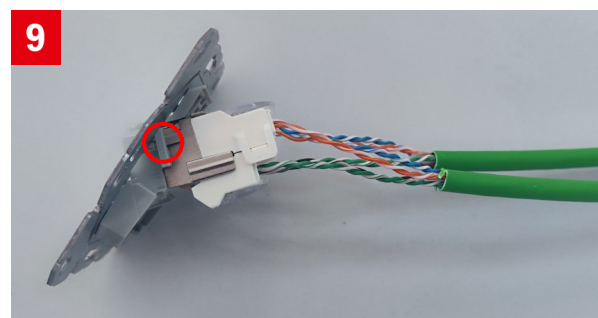

Insert the module into the side guides of the adapter and press it in. At the end of the process, the module snaps into the adapter with a "click".

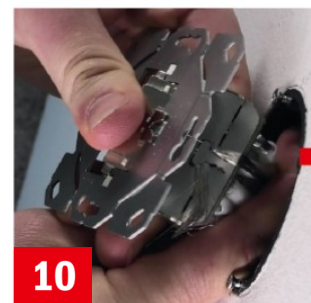

Press the module with the mounting plate into the wall box and make sure that none of the wires are squeezed. It is recommended to give the wire pairs a slight S-shaped bend (see Figure 10). Screw the mounting plate firmly in place.



Install central cover and (optional) cover frame by fastening the pre-assembled screw and insert labeling strip or printed label (up to 10 mm width).